

WARRANTY

 Limited Lifetime – Residential
 Limited 25-year – Commercial

Manufactured from Swanstone solid surface
 (see page 2 for detailed information)

Recommended for high use traffic areas and commercial surfaces
FEATURES

- Reinforced solid surface means color and texture run all the way through and cannot wear away
- Renewable surface will not wear away
- Coordinates with Swanstone shower and bath systems
- Wide variety of sizes and colors
- Easily accommodates all faucet styles
- Chemical resistant—acetone will not harm
- Heat resistant—hot curling irons will not burn
- Make-up and hair-dye can be buffed out with household cleansers
- ADA compliant when installed according to ADA Accessibility regulations.
- Larger bowl, thicker edge and taller back splash are an updated version of our Ellipse vanity tops

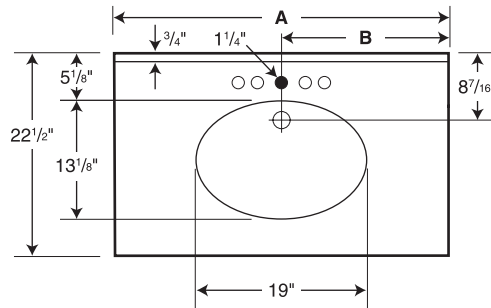

○ Drill Points ● Pre-drilled

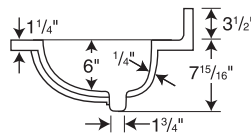

Capacity: 2 gallons to overflow

Model	A	B
CH1B2225	25"	12-1/2"
CH1B2231	31"	15-1/2"
CH1B2237	37"	18-1/2"
CH1B2243	43"	21-1/2"
CH1B2249	49"	24-1/2"
CH1B2255	55"	27-1/2"
CH1B2261	61"	30-1/2"

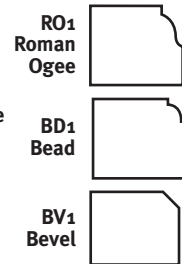
Custom Edge Treatments Available
 (orders cannot be cancelled or returned)

SPECIFICATIONS

Chesapeake Single Bowl Vanity Tops

Model	Part	Nominal Dimensions	Ship Wt. Lb.	Ship FedEx	Carton Dims. In.	Cu. Ft.
CH1B2225	CH02225	22-1/2" D x 25" W	22	FedEx	28 x 26 x 14	5.90
CH1B2231	CH02231	22-1/2" D x 31" W	27	FedEx	35 x 26 x 14	7.37
CH1B2237	CH02237	22-1/2" D x 37" W	28	FedEx	41 x 26 x 14	8.64
CH1B2243	CH02243	22-1/2" D x 43" W	40	FedEx	47 x 26 x 14	9.90
CH1B2249	CH02249	22-1/2" D x 49" W	46	FedEx	53 x 26 x 14	11.16
CH1B2255	CH02255	22-1/2" D x 55" W	52	-	58 x 25 x 13	10.91
CH1B2261	CH02261	22-1/2" D x 61" W	59	-	64 x 27 x 14	14.00

Kit Includes: One compression molded vanity top with overflow and integral bowl and back splash plus complete installation instructions.

Packaging: Each Swanstone unit is packed in a rectangular carton.

ACCESSORIES

- Optional CHVTSS Side Splash available (See page 45)
- Optional Front and Side Apron available (See page 45)

STANDARDS AND RATINGS

Class 1A fire rating

American National Standard Institute—ANSI Z124.3

International Association of Plumbing and Mechanical Officials (IAPMO)—listed

cUPC listed—Certified to CSA Standard B45 by IAPMO

National Sanitation Foundation-NSF Splash Zone, -NSF Food Zone

American Society for Testing and Materials

National Electrical Manufacturers Association

For a complete list of tests and results see the Technical Data Sheet – page 141.

SUPPORT DOCUMENTS

 Installation instructions available on line at www.swanstone.com
 **MADE IN USA.**
COLORS

(See inside back cover for color sample.)

Solid Colors:

- White (010)
- Bone (037)
- Bisque (018)

Aggregate Colors:

- Acorn (123)
- Almond Galaxy (046)
- Arctic Granite (035)
- Baby's Breath (168)
- Barley (091)
- Bermuda Sand (040)
- Canyon (124)
- Caraway Seed (169)
- Cloud Bone (126)
- Cloud White (125)
- Cornflower (063)
- Glacier (121)
- Golden Steppe (128)
- Gray Granite (042)
- Ice (130)
- Indian Grass (071)
- Mountain Haze (129)
- Night Sky (012)
- Pebble (072)
- Prairie (122)
- Purple Sage (064)
- Seafoam (074)
- Sierra (094)
- Tahiti Desert (050)
- Tahiti Gray (053)
- Tahiti Ivory (059)
- Tahiti Matrix (058)
- Tahiti Sand (051)
- Tahiti Terra (055)
- Tahiti White (011)
- Tundra (131)
- Winter Wheat (060)

MAINTENANCE AND CLEANING INFORMATION

 Cleaning regularly with liquid cleansers such as Dow or Lysol foaming bubbles is recommended. If necessary, Ajax, Comet, Soft Scrub, Bon Ami, Barkeeper's Friend and similar abrasive cleaners are safe and effective for use with a Scotch-Brite, Mr. Clean Magic Eraser or other similar pads and sponges. Lime-Away, Rust Out, Whink or other similar mineral-stain removers are acceptable as well. **Do not use** SOS, Brillo or other metal scouring pads.