



Cedar Trellis Screen

(TS33U Unassembled Kit)

For your convenience we use Recex multi-drive, rust-resistant zinc plated hardware.
You will need a #2 Philips or Robertson driver, wood glue & a hammer. (Staple/Nail gun optional)

Package Contents:

- (A) Vertical Lath... 2
- (B) Vertical Lath... 3
- (C) Horizontal Slat... 11
- (D) Nailing Strips... 4
- (E) 4" Spacer Block... 2
- (F) Posts... 2
- (G) X-Member... 2

Hardware:

- 2 ½" Screw... 8
- ¾" Nail... 110
- 1" Nail... 32

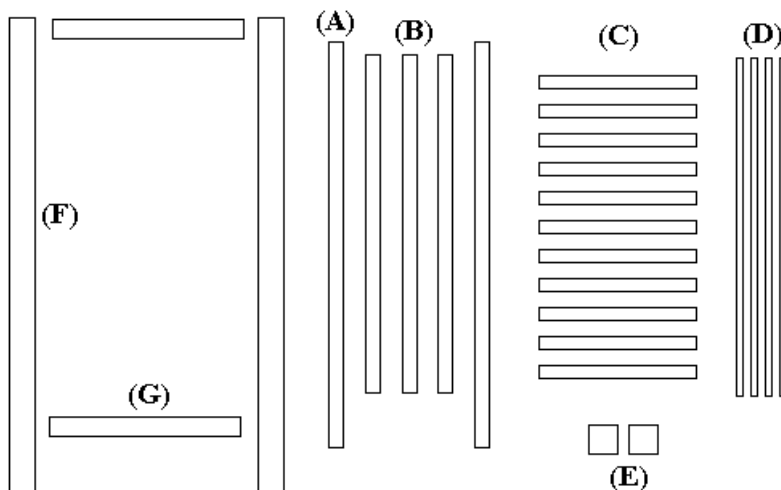

Note: A stapler or nail gun can be used as an alternative to join the slats together.

Step 1. Build Frame

- Arrange X-Members between posts and fasten together using 2 ½ inch screws.
- Lower x-member should be attached 7 inches up from bottom of posts as illustrated below.

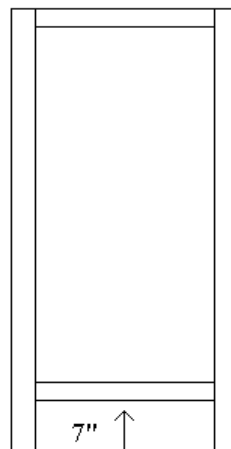

Step 2. Arrange Vertical Lath

- Inside the frame lay out the 3 shorter lath (B) between the 2 longer lath (A).
- Use 4" spacer blocks to attain a uniform distance between all vertical lath.

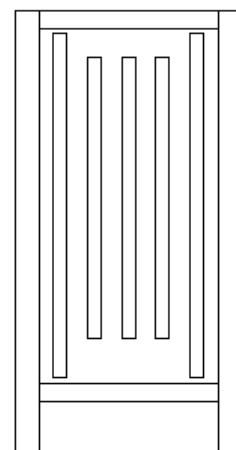

Step 3. Attach Horizontal Slats

- Set the 11 horizontal slats (C) across vertical lath.
- Use the 4" spacer block to attain a uniform distance between horizontal slats.
- Apply a dab of wood glue to strengthen each join – do not nail into place until all 11 slats have been positioned.
- Once you are satisfied with the arrangement, use 3/4" nails or staple gun to tack lattice together. (use 2 nails per join)

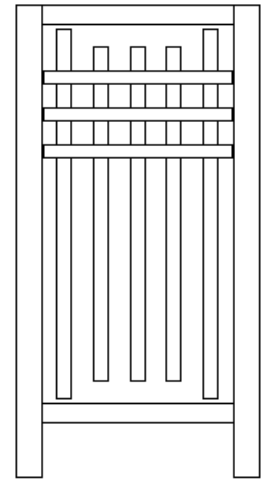

Step 4. Attach Trellis Panel To Frame

- Slip 2 nailing strips under the panel along the inside of each post.
- Place 2 more nailing strips on top of trellis panel and tight against posts.
- Tack nailing strips to posts using (8) 1 inch nails per strip
- Flip entire frame assembly over and tack nailing strips to backside of panel as above.

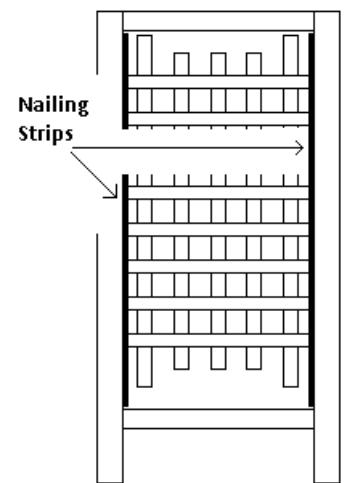

If you purchased the Trellis Screen Set please see below for hinge placement.

Hinge Placement

- Set 2 Trellis Screen Panels flat on ground – side by side.
- Measure 10 inches in from top of post and attach a hinge.
- Measure 10 inches from bottom of post and attach a hinge.
- Measure 40 inches from end of post and attach the middle hinge.

Trellis Anchoring Hints

Although the L-Shape will allow your Trellis Screen to sit as a free standing unit, you may want to use anchors if you are in a windy area.

To anchor your new Trellis Screen you can use a 2 foot section of rebar hammered into the ground and then wired to each post – or your local hardware store will have suitable post anchors that can be used in a similar fashion.

If attaching to a deck a simple L-Bracket can be used to secure to the deck floor.