

# SA3221R-3

# Box List

Item No:	SA3221R-3	Worker	Q	C	ganger
Box					
Part name			Quantity		
Front wire(前网)			1pcs		
Back wire(后网)			1pcs		
Left wire(左网)			1pcs		
Right wire(右网)			1pcs		
Grill(密网)			1pcs		
Bottom grill(脚网)			1pcs		
Plastic bottom(胶盘)			1pcs		
Top panel(wire)(盖网)			1pcs		
Layer wire(层网)			2pcs		
Stairs(梯网)			2pcs		
Left & right legs(左右脚架)			2pcs		
Tube(方管)			2pcs		
Assembly Instructions(包装图)			1pcs		
Wheels(2寸8厘脚轮)			4pcs		
Feeders(4寸杯)			4pcs		
Holder(4寸合圈)			4pcs		
Screw bag(螺丝包)			1pcs		

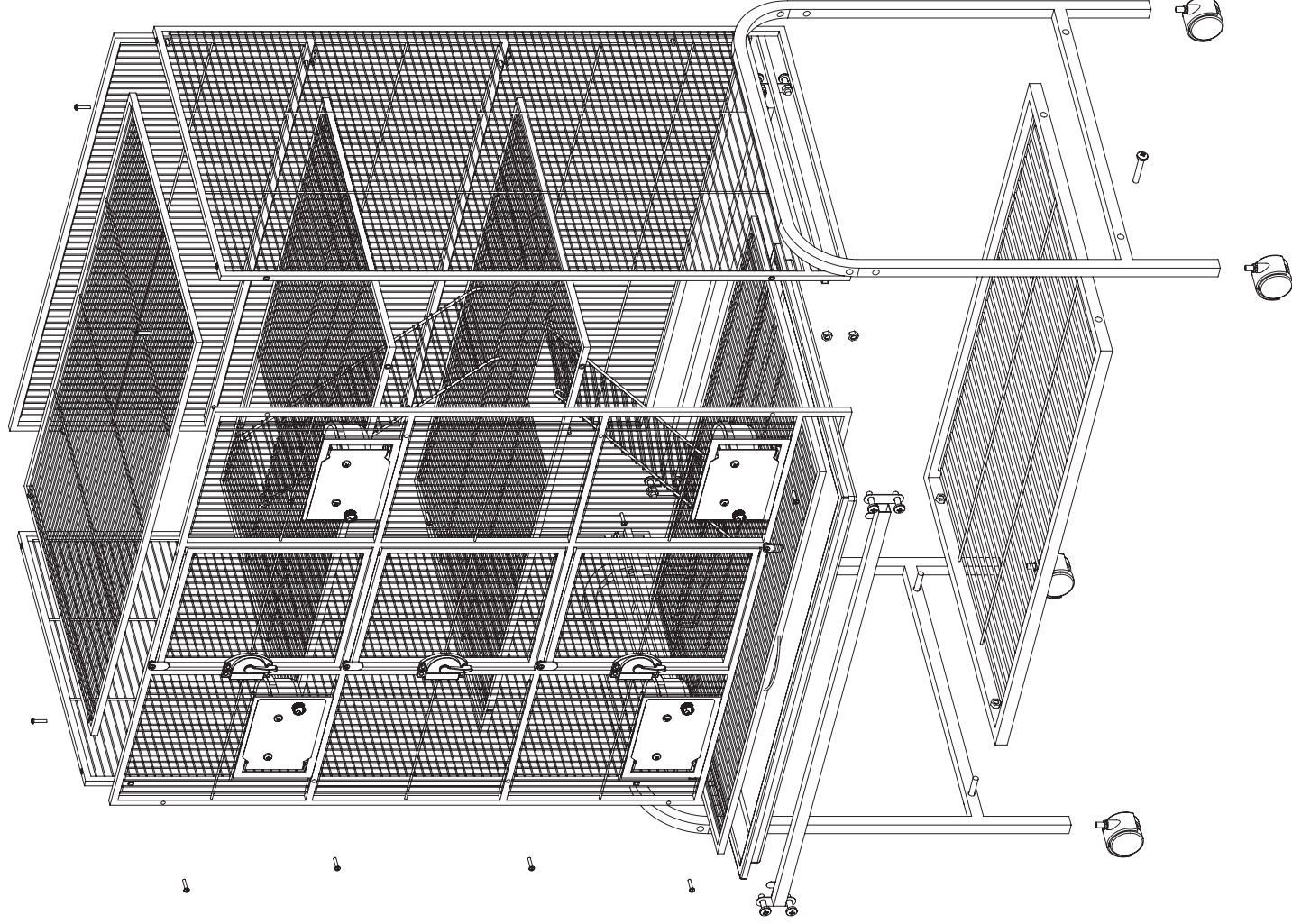

1. Attach left & right legs, tubes, bottom grill and wheels with screws form a stand.
2. Attach front, back, left, right wire mesh together with screws.
3. Attach layer wire, front wire and back wire with screws, and put stairs into the body as shown in picture.
4. Screw top wire mesh on top of front wire mesh and back wire mesh with M6X16 bolts and M6 nuts.
5. Slide grill in space underneath front wire mesh.
6. Slide plastic bottom in space underneath grill.
7. Put feeder cups on inside of body.
8. Put the cage on the stand.